

# Installation and Operation Manual



## Wireless Master Clock Synchronizer



The Wireless Master Clock Synchronizer is a compact wireless time receiver designed to provide a dry contact closure at a GPS accurate specific time of the day. The time of the synchronization pulse is programmable within the SiteSync IQ system controller to the nearest minute. The time of day and Master Clock Synchronizer module CAP code must be set correctly on the SiteSync IQ system controller to transmit a signal to the Master Clock Synchronizer. This manual provides instructions on making connections to your Master Clock Synchronizer module and setting your SiteSync IQ system controller to transmit to the module.

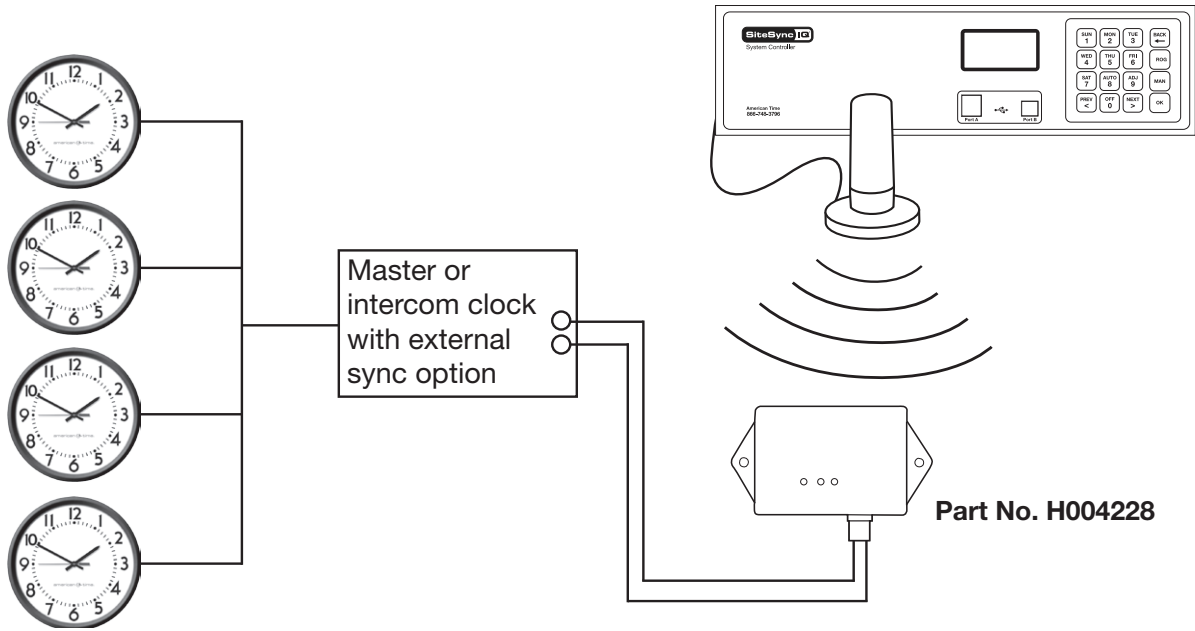

Figure 1 – Master Clock Synchronizer controlled by SiteSync IQ

**American Time**  
140 3rd Street South, PO Box 707  
Dassel, MN 55325-0707

Phone: 800-328-8996  
Fax: 800-789-1882  
american-time.com

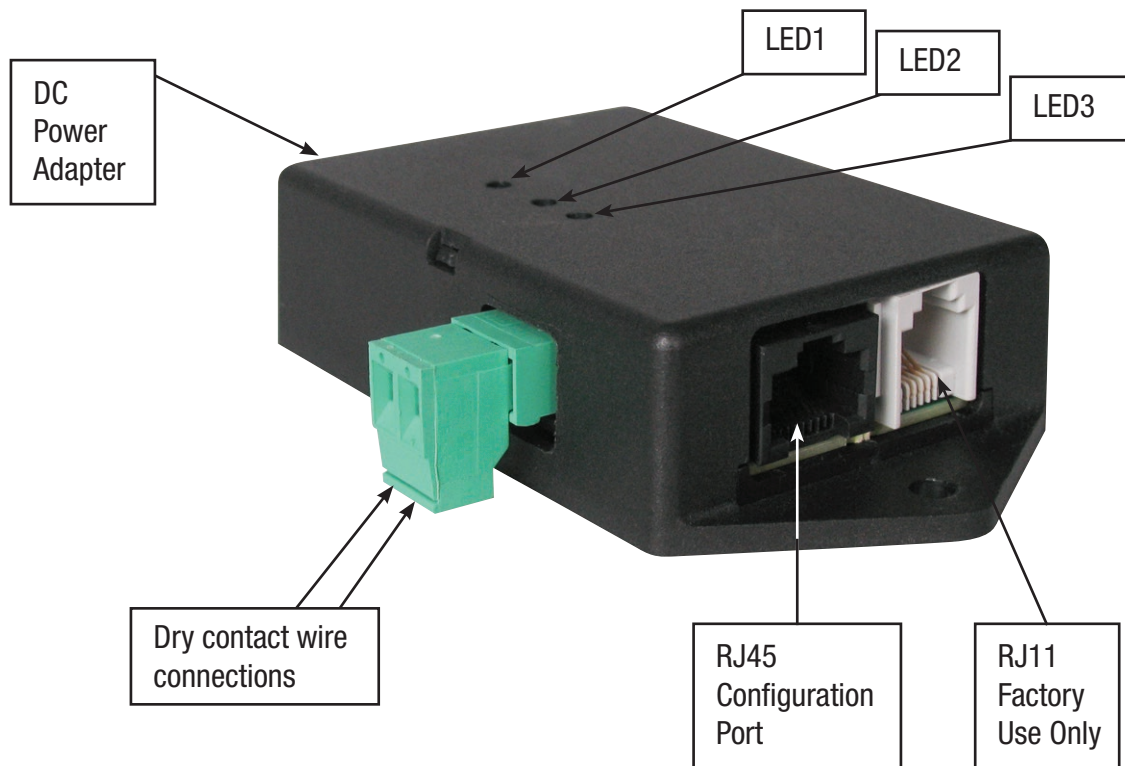

Figure 2 – Master Clock Synchronizer connections

To install your Master Clock Synchronizer module you will need to make two connections.

1. Connect power to the module using the DC power adapter supplied with the module from an AC wall outlet. Connect the adapter to the port indicated in figure 2.
2. Connect your time setting dry contacts to the module indicated in Figure 2.

#### LED Function

LED1 - Red = No signal 2 minutes

Green = Signal last 2 minutes

LED2 - Green = Relay active

LED3 - Yellow = Message Rec'd - A single yellow flash will indicate the relay activation message is received.

## Turn on the power to the System Controller

1 Set the SiteSync IQ System Controller to be a transmitter (Tx) of the contact closure. Press **PROG** **ADJ 9** to enter Master to Master (MTM) Menu.

2 Enter User Lock. Press **OK**.

3 a. Press **SUN 1** to set the SiteSync IQ System Controller to Tx.

b. Enter transmit duration (0-9999). Press **OK**.

Example: 2,000ms=2 seconds

■ **Note:** The SiteSync IQ System Controller will round up to the nearest second.

4 Using the keypad, set the time when the contact closure should occur. Use **PREV <** **NEXT >** to select AM or PM. Press **OK**.

■ **Note:** Reference existing equipment instruction manual for contact closure time.

■ **Important Note!** The Sync Time set in Step 4 must be the same for both units.

2  
MTM Menu  
Enter User Lock:  
PROG=Exit OK=Enter

3a  
MTM Menu  
Master to Master:  
1=Tx 3=Off  
2=Rx

3b  
MTM Menu  
Transmit Duration:  
2000  
OK=Done

4  
MTM Menu  
Sync Time:  
12:00:00  
◁AM/PM OK=Done