



FEATURES

- 1 Year Warranty
- AA battery movement
- Automatic synchronization to WWVB
- Time change for ST/DST fully automatic
- Stepper motor
- Integrated antenna
- High speed time setting
- Manual time setting backup feature
- Impact-resistant plastic case and polycarbonate crystal
- Sweep second hand
- Double dial mounting available
- Battery Booster (optional)

GENERAL

american time™ Radio Controlled clocks with optional Battery Booster, are attractive modern clocks that will complement any architectural style.

Our Radio Controlled clocks are equipped with miniaturized radio receivers to receive the time signal transmitted by the National Institute of Standards and Technology (NIST) from Fort Collins, Colorado. The time signal is based on the cesium clock, the most accurate timekeeping device in the world. The clock will automatically receive and compare the time signal with the time shown on the clock. In case of a deviation, the clock will automatically correct its time to agree with the time signal. This procedure is executed eight times a day to keep the clock on time.

DESCRIPTION

The **american time™** Radio Controlled clock uses one AA alkaline battery. Optional Battery Booster uses six AA alkaline batteries and extends maintenance free clock operation for 5+ years. It can be set to any U.S. time zone: PT, MT, CT, ET and be used as a radio controlled movement. It can also be set manually for areas that have poor signal. Once the time zone is set, pin pulled, and battery installed, the movement will search for the time signal. Once the signal is received and processed it will do a fast run until the correct time is achieved. This process can be achieved in as little as 3 minutes with good signal but typically will be achieved at night when signal strength is greatest. Factors such as weather, structural characteristics and topographical conditions can limit or interfere with signal reception. We recommend letting your clock search for the signal for at least 72 hours. If the clock hasn't corrected it means that it is in a location that cannot receive the signal. Move clock to a different wall and make sure that it is several feet from electronic/electrical devices or large metal surfaces or objects.

Clocks are provided in round only impact-resistant black plastic cases with shatter-resistant safety crystal and bold, black numerals and minute markers on a non-yellowing white dial. Stylish hour and minute hands are aluminum with a black finish and a red sweep hand. Optional bezel colors available.

*Movements may not work in all areas. We suggest a sample clock to make sure they will work for your application.

ORDERING INFORMATION

With Batter Booster Plus®

Part #	Description	Part #	Description
E56BAND301	12" Round surface	E56BAND301BP	12" Round surface
E92BAND201	12" Double dial ceiling	E92BAND201BP	12" Double dial ceiling
E93BAND201	12" Double dial wall	E93BAND201BP	12" Double dial wall
E66BAND301	15" Round surface	E66BAND301BP	15" Round surface
E63BAND201	15" Double dial wall	E63BAND201BP	15" Double dial wall
E62BAND201	15" Double dial ceiling	E62BAND201BP	15" Double dial ceiling

Double dial mounting requires a 4" square electrical box in the wall or ceiling.

Note: Personalized dial option available. Add L to the end of the Part #.

SPECIFICATIONS

Motor	Stepper	Normal Operation	1 Step/Sec
Operating voltage	1.25vdc to 1.70vdc	Nominal voltage	1.5vdc
Battery life	> 1 Year	Battery	AA alkaline
Setting time after reception	4 Minutes	Antenna	Built-in
Receiving time	3 – 16 Minutes	Operating temperature	23°F to 131°F (-5°C to +55°C)
Radio signal reception times	1:00, 3:00, 6:00, & 10:00 (AM & PM)	Gear alignment	12:00
Hand placement	12:00	Typical torque second hand	≥ 180μNm
Signal frequency	60 kHz		
Sensitivity	≤ 50μVm		

Surface mount plastic

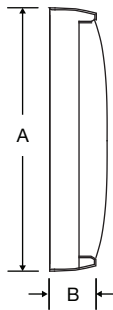

OUTSIDE DIMENSIONS SURFACE

SIZE	A	B	C
12"	13¼"	2½"	NA
15"	16"	2½"	NA
DOUBLE DIAL (12" & 15" only)			
12"	13¼"	15"	8 ⁵ / ₈ "
15"	16"	19¼"	8 ⁵ / ₈ "

Wall mount plastic double dial

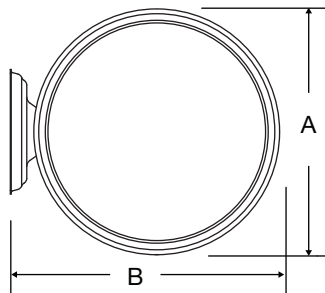

Ceiling mount plastic double dial

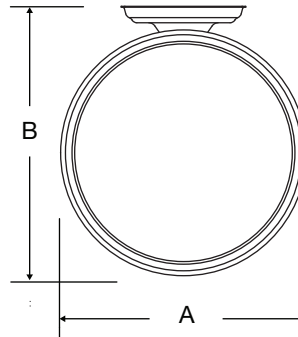

Plastic double dial profile

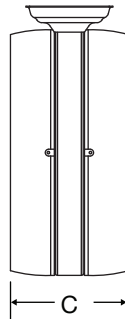

At American Time, we continually strive to improve our products to meet our customers' needs and to provide the best possible value. The above specifications are believed to be correct, are subject to change without notice and may otherwise vary from the above. Please call if you need verification of any specifications or the suitability of a particular product for a particular application. © American Time