



**FEATURES**

- **5 Year Warranty**
- UL/cUL Listed - 12" surface mount only
- Microprocessor controlled movement
- 15 minutes of backup power (no batteries required)
- Accuracy to within ±1 second of a master clock
- Reduced power consumption
- Attractive modern design
- Impact-resistant black plastic case
- Shatter-resistant safety crystal
- Diagnostic LED

**DESCRIPTION**

The **american time**™ AllSync Plus clocks are provided in **round only** high impact black plastic cases with clear polycarbonate crystals and bold, black numerals and minute markers on a non-yellowing white dial. Stylish hour and minute hands are aluminum with a black finish and a red sweep hand. Other bezel colors available. Consult factory.

The **american time**™ AllSync Plus clock is designed to work with multiple master clocks and correction signals. This unit is programmed to identify the signal it receives from the master and operate as that style of clock. Changing clock operation from one style to another is as easy as unplugging the clock from one system and plugging it into another. If needed, changing the placement of two small jumpers on the circuit board can change the voltage required to run this clock from 120vac to 24vac or 24vac to 120vac. This clock provides 15 minutes of backup run power without the use of batteries. If a power outage should last longer than 15 minutes, the clock will synchronize to the master clock at the hourly and 12 hour correction cycles.

**Correction Signals**

Works on:

- Hourly Correction: 28.75-35 seconds starting at the 59th minute and 30th second. 12 hour correction: 13 minutes and 52 seconds-18 minutes and 8 seconds starting at 5:12:00 (am and pm). Note: This protocol switches off the run line during the hourly correction.

**ORDERING INFORMATION**

Part #	Description	Part #	Description
U44BAGA304	10" Rd Surface 120vac	U44BAHA304	10" Rd Surface 24vac
U45BAGA?04	10" Rd Flush 120vac	U45BAHA?04	10" Rd Flush 24vac
U54BAGA304	12" Rd Surface 120vac	U54BAHA304	12" Rd Surface 24vac
U55BAGA?04	12" Rd Flush 120vac	U55BAHA?04	12" Rd Flush 24vac
U53BAGA204	12" Rd Double dial wall 120vac	U53BAHA204	12" Rd Double dial wall 24vac
U52BAGA204	12" Rd Double dial ceiling 120vac	U52BAHA204	12" Rd Double dial ceiling 24vac

**Note:**

Double dial mounting requires a 4" square electrical box in the wall or ceiling.

Surface clocks have a molded in hanger in the plastic cases.

12" surface clocks come complete with security bracket

Replace the ? in the part number with the number from the list below that will correspond with the system you're replacing.

New flush mount installations require backboxes.

**0 = Faraday    1 = National    5 = Simplex®    6 = Cincinnati/Edwards**  
**7 = 2-hook    8 = Setco    9 = R&H (keyhole)**

**Note:** Personalized dial option available. Add L to the end of the Part #.

**SPECIFICATIONS**

- 24vac/60 Hz or 120vac/60Hz
- Current draw: Single dial:  
 24vac, 1 watt, .043 amps  
 120vac, 3 watts, .028 amps  
 Double dial:  
 24vac, 2 watt, .086 amps  
 120vac, 3 watts, .056 amps

Maximum operating voltage: 24vac setting = 40vac  
 120vac setting = 150vac  
 Minimum operating voltage: 24vac setting = 15vac  
 120vac setting = 50vac

**GENERAL**

Types of secondary clocks compatible with AllSync Plus:

American Time X\* Series

Standard™ Electric CR & GRC 109106 through 109155 Series and 105047 through 105066 Series

\*Indicates more numbers before or after.

**OUTSIDE DIMENSIONS**

Flush mount plastic

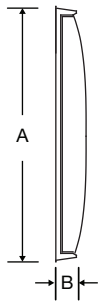

Flush		
SIZE	A	B
10"	9 <sup>7</sup> / <sub>8</sub> "	1 <sup>3</sup> / <sub>8</sub> "
12"	13 <sup>1</sup> / <sub>4</sub> "	2"

Surface		
SIZE	A	B
10"	10 <sup>9</sup> / <sub>8</sub> "	2 <sup>1</sup> / <sub>2</sub> "
12"	13 <sup>1</sup> / <sub>4</sub> "	2 <sup>1</sup> / <sub>2</sub> "

Double Dial			
SIZE	A	B	C
12"	13 <sup>1</sup> / <sub>4</sub> "	15"	8 <sup>5</sup> / <sub>8</sub> "

Surface mount plastic

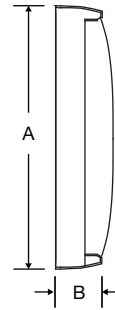

**Double Dial 12" only**

Wall mount plastic double dial

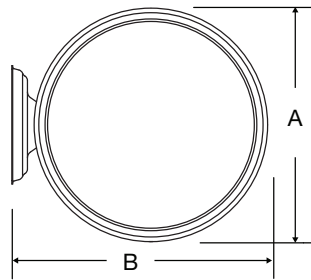

Ceiling mount plastic double dial

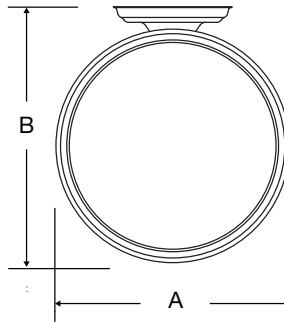

Plastic double dial profile

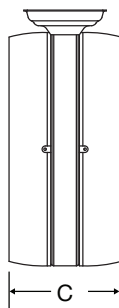

At American Time, we continually strive to improve our products to meet our customers' needs and to provide the best possible value. The above specifications are believed to be correct, are subject to change without notice and may otherwise vary from the above. Please call if you need verification of any specifications or the suitability of a particular product for a particular application. © American Time