

**Slim-Line Series
Battery Clocks
Molded Case**



Dial Style 04

FEATURES

- 3 Year Warranty
- Impact-resistant plastic case, with built-in hanger
- Shatter-resistant polycarbonate crystal
- Sweep second hand
- Double dial mounting available
- AA battery movement
- Battery Booster (optional)

GENERAL

The **american time**® Slim-Line battery clocks, with optional Battery Booster, are ideal for schools, hospitals, and state and federal buildings. Clocks are provided in round, high impact black plastic cases with shatter-resistant safety crystal and bold, black numerals and minute markers on a non-yellowing white dial. Stylish hour and minute hands are aluminum with a black finish and a red sweep hand. Optional bezel colors available.

DESCRIPTION

american time® Slim-Line Series battery clocks use a quartz-based battery movement which uses one AA alkaline battery. The Battery Booster holds six AA alkaline batteries in parallel, which extends maintenance-free clock operating life up to 5 years.

ORDERING INFORMATION

Part # Single Battery	Part # with Battery Booster	Description
E46BADD304	E46BADD304BP	10" Round, dial style 04
E56BADD304	E56BADD304BP	12" Round, dial style 04
E66BADD304	E66BADD304BP	15" Round, dial style 04
E93BADD204	E93BADD204BP	12" Round, Double dial wall, dial style 04
E92BADD204	E92BADD204BP	12" Round, Double dial ceiling, dial style 04
E63BADD204	E63BADD204BP	15" Round, Double dial wall, dial style 04
E62BADD204	E62BADD204BP	15" Round, Double dial ceiling, dial style 04

Change the 04 to select a different dial style. **Dial styles** shown below.

Change the BA (black) in the part number to select a different bezel color. All double dials and 15" available in black only.

Double dial mounting requires a 4" square electrical box in the wall or ceiling.

Note: Personalized dial option available. Add L to the end of the Part #. Call for details.

Color Selection

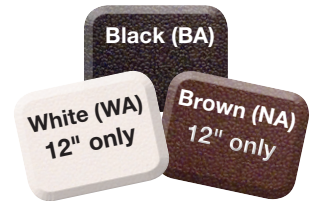

Dial Style 01



Dial Style 32



Dial Style 06

SPECIFICATIONS

Operating voltage	1.5vdc
Operating voltage range	1.2 to 1.7vdc
Current consumption	12" approx. 0.11mA; 15" 130mA
Motor output frequency	1 Hz
Operating temp range	23°F to 122°F (-5°C to +50°C)
Accuracy	Typical ±1 Sec/Day
Nominal torque at 1.5vdc	12" @1.5vdc=0.4 g/cm; 15" @1.35vdc=50 μNm
Quartz frequency	32.768 kHz

Surface mount plastic

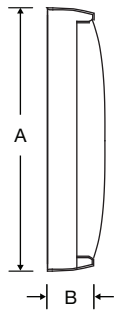

OUTSIDE DIMENSIONS

SURFACE

SIZE	A	B	C
10"	10 ³ / ₈ "	2 ¹ / ₂ "	NA
12"	13 ¹ / ₄ "	2 ¹ / ₂ "	NA
15"	16"	2 ¹ / ₂ "	NA

DOUBLE DIAL (12" & 15" only)

12"	13 ¹ / ₄ "	15"	8 ⁵ / ₈ "
15"	16"	19 ¹ / ₄ "	8 ⁵ / ₈ "

Wall mount plastic double dial

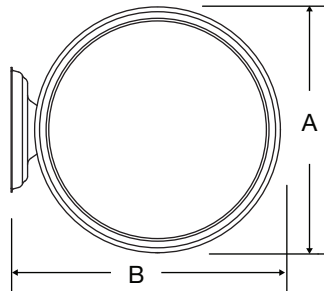

Ceiling mount plastic double dial

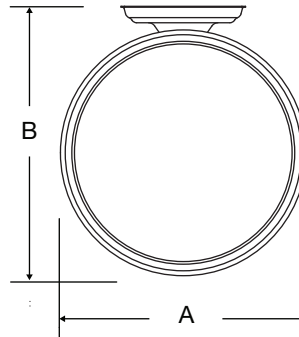

Plastic double dial profile

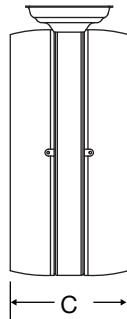

At American Time, we continually strive to improve our products to meet our customers' needs and to provide the best possible value. The above specifications are believed to be correct, are subject to change without notice and may otherwise vary from the above. Please call if you need verification of any specifications or the suitability of a particular product for a particular application. © American Time