

**Secondary Clocks
Synchronous-Wired Corrective
60th Minute Metal Case**
Manufactured in Dassel, MN



FEATURES

- **2 Year Warranty**
- Dual automatic clock correction cycles
 - > Hourly correction
 - > 12-hour scatter correction
- Quality heavy-duty brass gear train
- Precision 'Hysteresis' type *Synchron* motor
- Attractive Modern Design
- Heavy-duty construction
- Metal case
- Double dial mounting

GENERAL

The **American Time**® Synchronous-Wired corrective clocks are used with the AllSync IQ® master clocks to provide continuous accurate time indication. The secondary clocks are provided in round or square black powder coated metal bezels with glass (10", 12", and 18" clocks) or plexiglass (15" clocks) crystals and bold, black numerals and minute markers on a non-yellowing white dial. Stylish hour and minute hands are aluminum with a black finish and a red sweep second hand.

DESCRIPTION

American Time™ clocks may be surface, flush or double dial mounted and are available in 10", 12", 15" or 18" round and 12" square. Once each hour the master clock supervises the accuracy of the secondary clock system by issuing a 25 second signal that will correct secondary clocks up to 59 minutes slow. Every twelve hours the master issues a supervisory signal to correct units up to 11 hours, 59 minutes slow. The reference time for the hourly correction is the 60th minute. Twelve-hour correction occurs between 6:00 and 7:00 twice daily. Flush mount clocks require a flush backbox. Each clock is supplied with a pair of Molex® connectors.

ORDERING INFORMATION

Part #	Description		Part #	Description	
G44BHAG491	10" Rd Surface	120vac	G44BHBG491	10" Rd Surface	24vac
G45BHAG191	10" Rd Flush	120vac	G45BHBG191	10" Rd Flush	24vac
G54BHAG491	12" Rd Surface	120vac	G54BHBG491	12" Rd Surface	24vac
G55BHAG191	12" Rd Flush	120vac	G55BHBG191	12" Rd Flush	24vac
G57BHAG491	12" Sq Surface	120vac	G57BHBG491	12" Sq Surface	24vac
G58BHAG191	12" Sq Flush	120vac	G58BHBG191	12" Sq Flush	24vac
G64BGAG491	15" Rd Surface	120vac	G64BGBG491	15" Rd Surface	24vac
G65BGAG191	15" Rd Flush	120vac	G65BGBG191	15" Rd Flush	24vac
G74BHAG491	18" Rd Surface	120vac	G74BHBG491	18" Rd Surface	24vac
G75BHAG191	18" Rd Flush	120vac	G75BHBG191	18" Rd Flush	24vac
G52BHAG291	12" Rd DDC	120vac	G52BHBG291	12" Rd DDC	24vac
G53BHAG291	12" Rd DDW	120vac	G53BHBG291	12" Rd DDW	24vac
G50BHAG291	12" Sq DDC	120vac	G50BHBG291	12" Sq DDC	24vac
G51BHAG291	12" Sq DDW	120vac	G51BHBG291	12" Sq DDW	24vac
G62BGAG291	15" Rd DDC	120vac	G62BGBG291	15" Rd DDC	24vac
G63BGAG291	15" Rd DDW	120vac	G63BGBG291	15" Rd DDW	24vac

CFB101 10", 12", 15", 18" Flush backbox

Double dial mounting requires a 4" square electrical box in the wall or ceiling.

SPECIFICATIONS

Operating voltage 120vac 60 Hz motor = .033 amps Correction coil = .022 amps
 24vac 60 Hz motor = .144 amps Correction coil = .094 amps

Steel flush mount

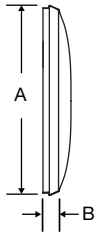

Steel surface mount

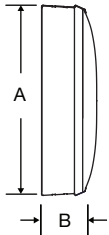

OUTSIDE DIMENSIONS

“A” Dimensions:

11¼" for 10" clocks
 13¼" for 12" clocks
 16¼" for 15" surface clocks
 16" for 15" flush clocks
 19" for 18" clocks

“B” Dimensions: Surface

2¼" for 10", 12", 15"
 3¼" for 18" clocks

“B” Dimensions: Flush

1⅝" for 10", 12", 15"
 1⅞" for 18" clocks

Double Dial:

Note: includes 2 surface clocks

“A” Dimensions:

13¼" for 12" clocks
 16¼" for 15" clocks

“B” Dimensions:

16⅞" for 12" clocks
 19⅞" for 15" clocks

“C” Dimensions:

8" for 12" & 15" clocks

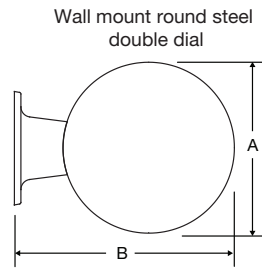

Ceiling mount round steel double dial

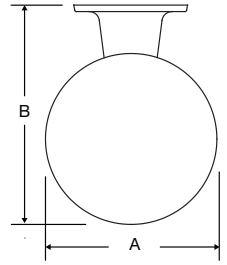

Steel double dial profile

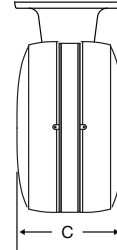

Flush mount steel square



Surface mount steel square



Square 12" only
OUTSIDE DIMENSIONS

Flush

“A” Dimensions:

12⅝"

“B” Dimensions: Surface

3¼"

“B” Dimensions: Flush

1⅝"

“B” Dimensions: Double Dial

17⅛"

“C” Dimensions: Flush

6⅝"

Wall mount steel square double dial mechanical

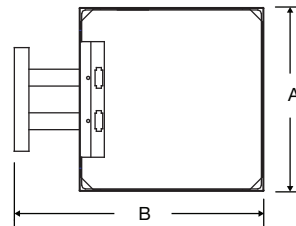

Ceiling mount steel square double dial mechanical

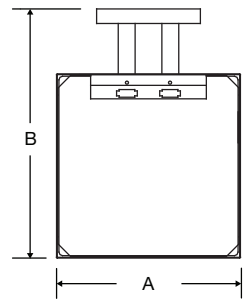

Steel square double dial profile



At American Time, we continually strive to improve our products to meet our customers' needs and to provide the best possible value. The above specifications are believed to be correct, are subject to change without notice and may otherwise vary from the above. Please call if you need verification of any specifications or the suitability of a particular product for a particular application.

© American Time