



FEATURES

- 3 Year Warranty
- Automatic Daylight Saving Time adjustment
- Aluminum case with built-in hanger
- Polycarbonate crystal
- Sweep second hand
- AA battery movement
- Battery Booster (optional)

GENERAL

The **American Time®** AllSet battery clocks, with optional Battery Booster, are ideal for schools, hospitals, and state and federal buildings. Clocks are provided in a round aluminum case with a polycarbonate crystal and bold, black numerals and minute markers on a non-yellowing white dial. Stylish hour and minute hands are aluminum with a black finish and a red sweep hand. The Battery Booster holds six AA batteries in parallel, which extends maintenance-free clock operating life to 5+ years.

DESCRIPTION

The AllSet quartz clock movement features a microchip with an internal battery that keeps track of the current date and time. The microchip is programmed to make the daylight saving time change at 03:00 am Eastern, 02:00 am Central, 01:00 am Mountain and 12:00 Pacific time twice a year. In the Spring, the movement will move the hands forward one hour, at an accelerated speed, to achieve the advance of one hour. In the Fall, the movement will automatically stop moving the hands for one hour and start ticking again when the clock is on time, to adjust back to standard time.

Clocks use a quartz-based battery movement which uses one AA alkaline battery. The optional Battery Booster holds six AA batteries in parallel which extends maintenance-free clock operating life to 5+ years.

Note: Time must be manually set at startup and after replacing the batteries. Internal time/date is only used for moving hands for DST changes.

ORDERING INFORMATION

Part #	Description	Part #
Stand-Alone		With Battery Booster
E54AGQD304	12" 04 dial style, surface	E54AGQD304BP
E64AGQD304	15" 04 dial style, surface	E64AGQD304BP

Note: Other dial styles available.

Note: Personalized dial option available. Add L to the end of the Part #.

SPECIFICATIONS

- Operating voltage: 1.5vdc
- Operating voltage range: 1.3 to 1.7vdc
- Operating temp range: 14°F to 122°F (-10°C to +50°C)
- Accuracy typical: ±1 Sec/Day
- Nominal torque at 1.5vdc: 1.5 g/cm @ second shaft

Surface

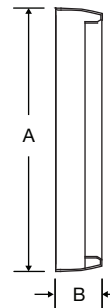

OUTSIDE DIMENSIONS

SIZE	A	B
Surface		
12"	13 ³ / ₈ "	2 ⁵ / ₈ "
15"	16 ¹ / ₄ "	2 ⁵ / ₈ "

At American Time, we continually strive to improve our products to meet our customers' needs and to provide the best possible value. The above specifications are believed to be correct, are subject to change without notice and may otherwise vary from the above. Please call if you need verification of any specifications or the suitability of a particular product for a particular application. © American Time