



PoE Analog Steel Case Clocks

Power over Ethernet (PoE) is a recognized standard (IEEE802.3af) for delivering power over an Ethernet cable. PoE uses a single CAT5 or higher Ethernet patch cable to provide both power and synchronization signals, which saves on installation costs and maintenance. It is recommended that an Uninterruptible Power Supply (UPS) be part of the Ethernet network system to maintain clock function during a power outage.

Clocks are provisioned and monitored through the inCloud Management Portal and setup app (Android OS) or Network Clock Connect. Events, such as triggering a buzzer clock, can also be scheduled.

FEATURES

- 3 Year Warranty
- Supports up to 10 SNTP servers for redundancy
- Supports DHCP or static IP addressing
- Easy initial mounting and setup
- Support for any time zone
- Supports Daylight Saving Time
- Heavy-duty black steel case
- Convex glass or polymer crystal (polymer only on 15" clocks)

CERTIFICATIONS

- Electromagnetic Emissions
 - EN 55032:2012/AC:2013 Class B
 - FCC 15.107:2018 Class B
 - FCC 15.109:2018 Class B
 - ICES-003:2016 Class B
- Electromagnetic Immunity
 - EN 55024:2010
- Safety CB

SPECIFICATIONS

Crystal	Convex glass or polymer (polymer on 15")
Clock hour & minute hands	Black
Clock second hand	Red
Weight	12" - 4.0lbs, 15" - 4.7lbs, Double Dial - 11.25lbs
Power consumption	PoE, IEEE802.3af compliant, 1W, 48v
Operating temperature	32°F to 104°F (0°C to 40°C)
Operating Humidity	95% maximum, non-condensing
Accuracy	±1 second

BUZZER OPTION SPECIFICATIONS

Dry Contacts	NO contacts with 2A 30vdc/0.5A 120vac rating and active closure time of 1-59 seconds
Sound Level	65dBA at 10ft



ORDERING INFORMATION

Part #	Part #	Description
Analog Option	Buzzer Option	
PE44BHPD904	PE46BHPD904B	10" round, surface mount
PE54BHPD904	PE56BHPD904B	12" round, surface mount
PE53BHPD204	PE93BHPD204B	12" round, double dial, wall mount
PE52BHPD204	PE92BHPD204B	12" round, double dial, ceiling mount
PE64BGPD904	PE66BGPD904B	15" round, surface mount
PE63BGPD204	PE63BGPD204B	15" round, double dial, wall mount
PE62BGPD204	PE62BGPD204B	15" round, double dial, ceiling mount

Accessories

TMA200	Single port PoE injector
H004167B-POE	USB Drive with Network Clock Connect Software
H001241	Security bracket for 12" surface clocks
H004061	Security bracket for 15" surface clocks

Bezel Finishes



Black Sand=BH/BG



Steel Gray=GH
(12" only)



White=WG
(12" & 15" only)

Note: Personalized dial option available. Add L to the end of the part number. Contact us for details.

Note: Replace the BH in the part # with GH for gray bezel finish or WG for white. See color swatches.

Note: For polymer lens on 10" and 12" clocks, replace the BH in the part # with the 2 letter code for the bezel finish. Additional cost.
BG=Black Sand with polymer lens. GG=Steel Gray with polymer lens.

OUTSIDE DIMENSIONS

ROUND

"A":

11¹/₄" for 10" clocks

13¹/₄" for 12" clocks

16¹/₄" for 15" clocks

"B" Surface:

2¹/₄" for all clocks

"B" Double dial:

14³/₈" for 12" clocks

17¹/₈" for 12" clocks

"C" Double dial:

8" for 12" & 15" clocks

Surface mount steel

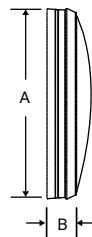

Wall mount round steel double dial

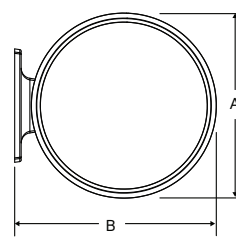

Ceiling mount round steel double dial

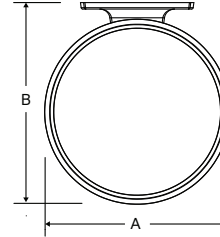

Steel double dial profile

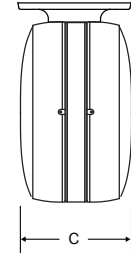

At American Time, we continually strive to improve our products to meet our customers' needs and to provide the best possible value. The above specifications are believed to be correct, are subject to change without notice and may otherwise vary from the above. Please call if you need verification of any specifications or the suitability of a particular product for a particular application.

© American Time